

CINEBAR 560 Soundbar



Ba11



User Manual

Designed For Excellence.

www.iball.co.in

Thank you for choosing **CINEBAR 560 soundbar**. Please read the user manual carefully before operation and save this user manual for further reference.

WARNING

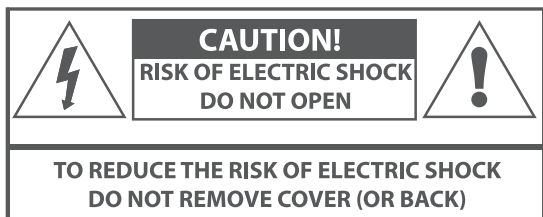

Caution :

- To reduce the risk of electric shock, do not dismantle the product and do not expose the apparatus to rain or moisture. No user - serviceable arts inside.
- Refer servicing to qualified personnel only. *Avoid self-disassembly of the speaker, Kindly approach our service team with reference to the following link for service support :*

Warranty Policy

The lightning flash within an equilateral triangle is intended to alert you to the presence of uninsulated dangerous voltage within the product's enclosure that may be of sufficient

magnitude to constitute an electric shock to a person or persons.



Important! This symbol alerts you to read and observe important warnings and instructions on the unit or in this manual.



IMPORTANT SAFETY INSTRUCTIONS :

This appliance is not intended for use by persons (including children) with reduced physical sensory or mental capabilities, or lack of experience and knowledge, unless they have been given supervision or instruction concerning use of the appliance by a person responsible for their safety.

Children should be supervised to ensure that they do not play with the appliance.

1. To prevent possible hearing damage, do not listen at high volume levels for longtime periods or a sudden high volume level.



2. Never use the device unsupervised! Switch off the device whenever you are not using it, even if not using it only for a short while.
3. The appliance is not intended to be operated by means of an external timer or separate remote control system.
4. If the supply cord is damaged, it must be replaced by the manufacturer, its service agent or similarly qualified persons in order to avoid a hazard.
5. Before operating this system, check the voltage of this system to see if it is identical to the voltage of your local power supply.
6. The unit should not be impeded by covering the ventilation opening with items such as newspaper, table-cloths, curtains etc. Make sure that there are at least 20 cm of space above and at least 5 cm of space on each side of the unit.
7. The apparatus must not be exposed to dripping or splashing liquid, no objects filled with liquids such as vases, should be placed on the apparatus.
8. To prevent fire or shock hazard, do not expose this equipment to direct heat, rain, moisture or dust.
9. Do not position this unit near any water sources e.g. taps, bathtubs, washing machines or swimming pools. Ensure that you place the unit on a dry, stable surface.
10. Do not place this unit close to a strong magnetic field.

11. Do not place the unit on a amplifier or receiver.
12. Do not place this unit in a damp area as the moisture will affect the life of electric components.
13. Do not attempt to clean the unit with chemical solvents as this might damage the finish. Wipe with a clean, dry or slightly damp cloth.
14. When removing the power plug from the wall outlet, always pull directly on the plug, never pull on the cord.
15. Depending on the electromagnetic waves used by a television broadcast, if a TV is turned on near this unit while it is also on, lines might appear on the LED TV. Neither this unit nor the TV is malfunctioning. If you see such lines, keep this unit well away from the TV set.
16. The mains plug is used to disconnect the device, the disconnected device should remain readilyoperable.

Power Source:

This soundbar is designed to operate in AC 220V - 240V 50/60Hz.

Product representation : Soundbar



1. DISPLAY
2. AUX
3. OPTICAL
4. HDMI (ARC)
5. USB
6. POWER BUTTON
7. VOL +
8. VOL -
9. INPUT MODE

Subwoofer and Satellite

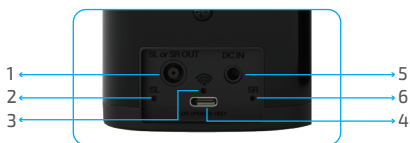

1. Wireless Surround SL or SR out (wireless surround Channel is fixed, when end user's power socket position isn't matched, please press switch button from bottom of surround speaker to exchange channel position).
2. Wireless surround SL channel LED light.
3. LED indicator: Indicates the pairing between soundbar and wireless surround seaker.
4. for Software Upgrade only.
5. DC IN.
6. Wireless surround SR channel LED light.

Remote Control :

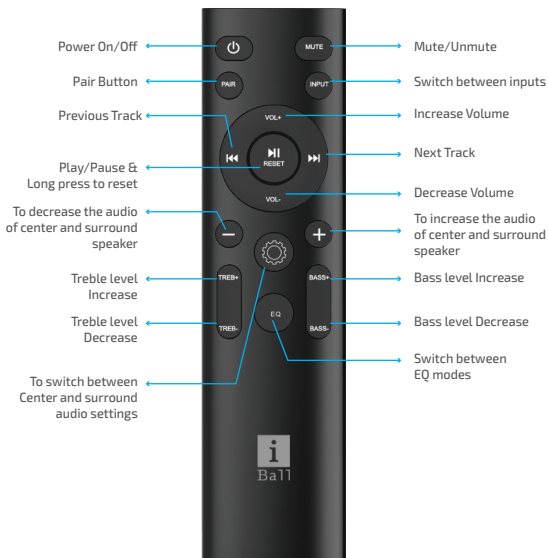

Positioning the soundbar :

Place on a flat Surface :

Place the soundbar horizontally on a flat surface such as a TV unit or shelves and align it centrally with the TV screen. Allow some space between the speaker and the wall. Don't place inside a cabinet or on a walled shelf. Follow this guidance for best sound output and good airflow around the soundbar.

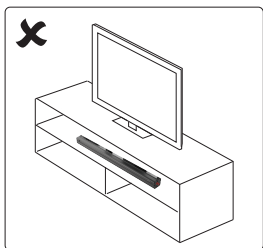
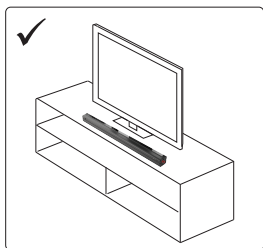

Mount on the wall :

WARNING : If you don't feel confident to correctly and securely wall-mount the soundbar, Seek the assistance of an experienced person or professional.

Install the speaker on a vertical, fast, reinforced area of wall. For plaster walls, it is recommended to screw into wall studs for greater security. For optimum performance, allow at least 25mm/1" distance between the soundbar and the TV.

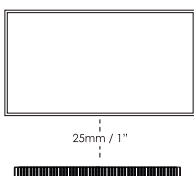
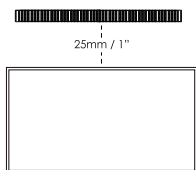

Follow below steps to mount the sound bar on the wall :

1. Make 2 holes on the wall with distance same as the wall bracket on the soundbar.
2. Put the plastic anchors onto the wall and secure the screws to the plastic clip, do not tighten the screws all the way make sure leave some space.
3. Attached the 2 EVA pads onto the wall mount bracket. This will make sure that there is enough room between the wall and the soundbar outlet, minimum 15mm.
4. Once the screws securely fastened, hang the soundbar over by inserting the screws onto the wall mount bracket.

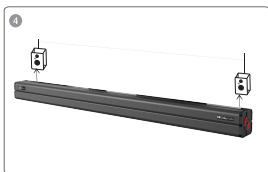
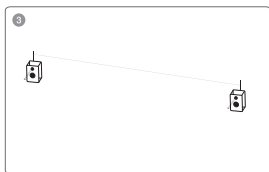
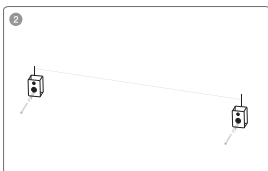
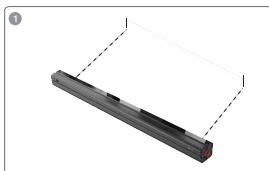

Follow below steps to mount the surround speaker on the wall :

1. Open 4 holes on the wall. For the distance between the 2 holes, please refer to the soundbar

bracket wall mounting.

2. Fasten the plastic anchors in the 4 holes of the wall mount bracket.

3. Then attach the provided screws to the plastic anchors and tighten the screws to ensure that the wall mount bracket does not shaking.

4. Place the surround sepakers on bracket with the corresponding holes at the bottom, then fix the provided screws in the bottom of the bracket and the holes of the surround speakers, then tighten the screws.

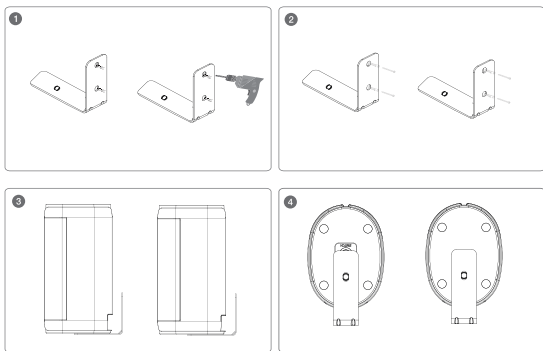

CONNECTIVITY PROCEDURE :

Setting the Soundbar :

1. Plug in the power cord and the display will light up (Standby mode).

2. Switch on the soundbar by using power button on soundbar or by using "STANDBY" button

on remote. After switching on, the default input mode will appear on display.

3. Input mode can be changed by pressing the power button again or by using the "INPUT" button on remote.

4. Below are input mode names appearing in the soundbar display:

bt : BT Pairing Mode

Hd : ARC Mode

USB : USB Mode

AUX : AUX Mode

OPT : Optical mode

Playing Audio via BT Connection :

1. Turn on the soundbar and then short-press the "INPUT" button on soundbar or remote controller to switch it to BT mode and LED display on the soundbar will flicker in the BT pairing mode.

2. Activate the pairing function on your phone or other compatible device and select by **iBall CineBar 560** by BT connection.

3. When successfully paired, you will hear a tone and LED display will turn on "bt" and stop flickering. Then music that you selected can be played on the soundbar.

4. The remote control includes BT mode playback controls.

Playing Audio via USB Port :

The soundbar automatically switches to

USB input mode with the LED display (USB) when a USB flash drive is inserted (this mode isn't selectable on the soundbar or remote control unless a USB flash drive is connected).

1. Ensure that your USB flash drive contains MP3 audio files (other file types not supported).
2. Connect the USB flash drive to the USB port on the soundbar (or your own USB extension cable connected to the USB port); music will automatically play.

Audio input (AUX) Connection :

1. Connect the soundbar to your PC, tablet, smartphone, TV, or other device using the included audio cable short-press the input button to switch to audio input mode with the LED Display lit up (AUX).
2. In this mode, playback can only be controlled on your connected device.

ARC Mode :

1. The Soundbar supports HDMI with Audio Return Channel (ARC). If your TV is HDMI ARC compliant, you can hear the TV audio through your soundbar by using a single HDMI cable.
2. Using a High Speed HDMI cable, connect the HDMI (ARC) connector on the soundbar to the HDMI ARC connector on the TV. The HDMI ARC connector on the TV might be labelled differently. For details, see the TV user manual.
3. When connecting a device such as a

TV/Set-top box/DVD/Game console with TV (ARC) cable, set the audio output mode of the source device to Dolby or Auto mode <digital TV (ARC) output>.

NOTE :

- *The TV is connected to a TV (ARC) port with soundbar. Different TVs might have different setup menus, but the operation approach is the same.*
- *If needs to connect set-up box meanwhile, please firstly connect the TV (ARC) connector and paired to the soundbar. Then connect the set-top box.*

Optical Mode :

1. Press the Input button on the remote control to select optical mode.
2. Connect the optical cable to the optical digital output of your TV.
3. When connecting a device such as a TV/Set-top box/DVD/Game console with optical cable, set the audio output mode of the source device to Dolby or Auto mode (digital optical output).

NOTE :

- *Do not bend the optical cable, otherwise the cable inside will be damaged.*

Features :

- 800W RMS Power
- 20.32 cm Deep Bass
- Soundbar with Three Drivers
- Connectivity : BT v5.3 | TV (ARC) | Optical In | USB | AUX
- Premium Gloss Finish
- Perforated Mesh
- Front LED Display
- Wall Mountable Design
- Remote control

Specification :

BIS Name : iB1921

Output Power (RMS)

Subwoofer : 410W

Soundbar : 80W x 3

Satellite : 75W x 2

Total : 800W

Driver Size

Subwoofer : 20.32 cm x 1

Soundbar : 5.08 cm x 3

Satellite : 5.08 cm x 2

Impedance

Subwoofer : 3Ω

Soundbar : 6Ω

Satellite : 6Ω

Frequency Response : 55Hz-20KHz

S/N Ratio	: ≥ 78 dB
Separation	: ≥ 48 dB
File format support	: MP3
Line input	: TV (ARC) Optical AUX
Max Supported USB memory size	: 32GB
BT Name	: iBall CineBar 560
BT Version	: 5.3
Product Dimension (W x D x H)	
Subwoofer	: 19 x 35 x 41 cm
Soundbar	: 95 x 7 x 7 cm
Satellite	: 7.7 x 7.7 x 19 cm
Net.Weight	
Subwoofer	: 6.3 kg
Soundbar	: 2.4 kg
Satellite	: 1.2 kg
Total	: 9.9 kg

Package Contents :

Soundbar	: 1 U
Subwoofer	: 1 U
Satellites	: 2 U
Power Adapter (Satellite)	: 1 U
Input Cable	: 1 U
Remote	: 1 U
Quick Start Guide (QR)	: 1 U
Wall Mount Kit	: 1 U



ISO 9001:2015 Certified Company
Since 2001 | www.iball.co.in